

MEET *the* PRIMES

8:00 a.m. – 9:00 a.m.
SESSION
FEATURING



CONSTRUCTION

PCL CONSTRUCTION SERVICES

| *HOW TO DO BUSINESS WITH PCL*



CONSTRUCTION

AGENDA



Introduction

Who is PCL?

Our Projects

How to Prequalify

Questions

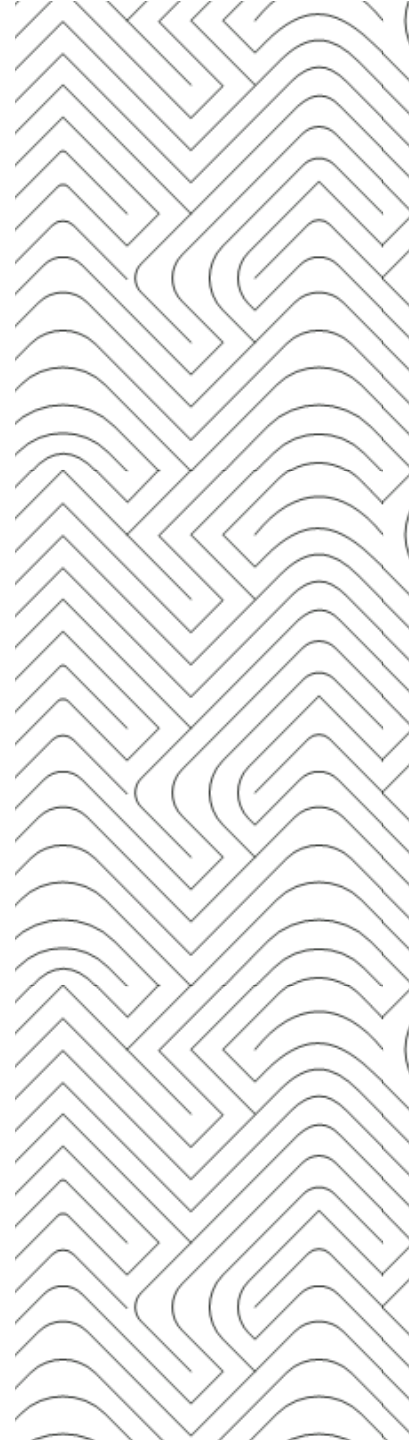

INTRODUCTIONS



CONSTRUCTION

PCL TEAM

| PRESENTERS

KAYLA MONTGOMERY
Diversity & Inclusion Specialist



PATRICK GOFORTH
Project Manager



Anthony Le
Senior Estimator



SHANE LUNDEBERG
Prequalification Coordinator



WHO IS PCL?



CONSTRUCTION

PCL FAMILY

| Building a better future, together.



#2 ENR Hospitality Contractor



#9 ENR Largest Contractor



#3 Contractor in LA County (LABJ)



Available self-perform team

35 YEARS BUILDING IN CALIFORNIA





OUR MARKETS

- ▶ Sports + Entertainment
- ▶ Higher Education
- ▶ Aviation
- ▶ Hospitality
- ▶ Commercial
- ▶ Multifamily Residential

D&I SPEND

| Building a better future, together.

40% OF OUR
SUBCONTRACTOR
DATABASE IS COMPRISED
OF DIVERSE BUSINESSES.

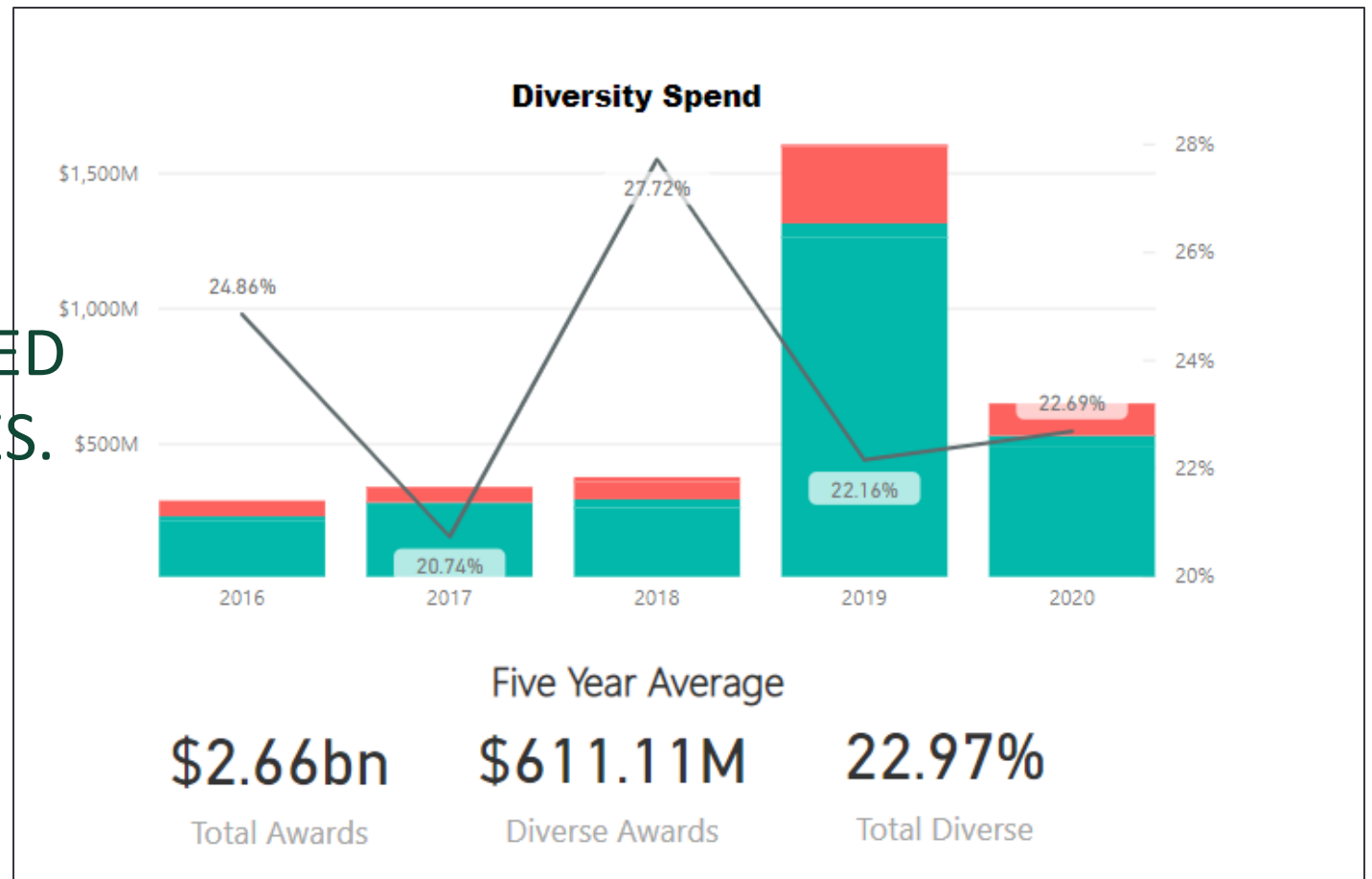

PROCUREMENT

| What We Buy

- Construction Supplies
- Construction Tools
- Heavy Equipment
- Temporary Toilets
- Temporary Fencing
- Lumber
- Pest Control
- Printing Reprographics
- Waste Services/Dumpsters
- Drawing Reproductions
- Office Supplies
- SWAG
- Trailer Cleaning
- Trailers
- Security Services
- Traffic Control
- Trailer Alarm
- Project Signage
- Project Photos / Web Camera
- Testing + Inspections
- Final Cleaning
- SWPPP



WORKFORCE DEVELOPMENT

- ▶ Good Neighbors
- ▶ 205+ New Careers in Construction
- ▶ Apprenticeship Readiness Program Partners
- ▶ Community Engagement

OUR PROJECTS



CONSTRUCTION



CONSTRUCTION

LOS ANGELES

| Building a better future, together.



UC Riverside, Parking Structure 1

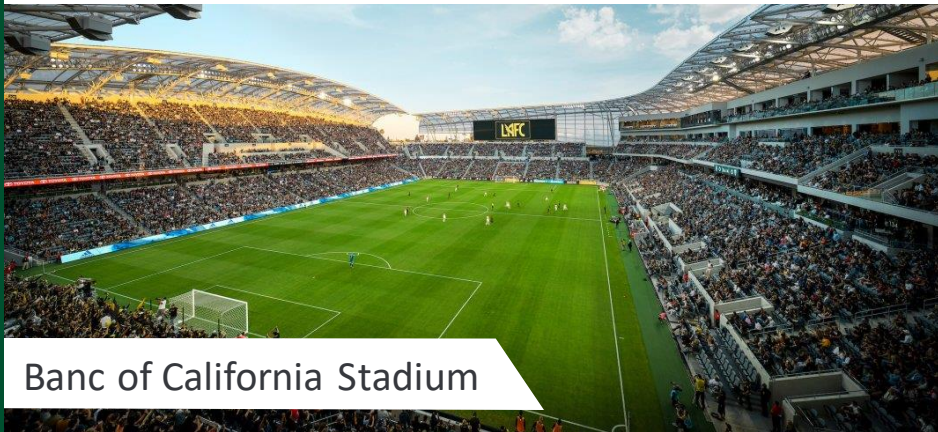

Banc of California Stadium



LAX Consolidated Rental Car Facility

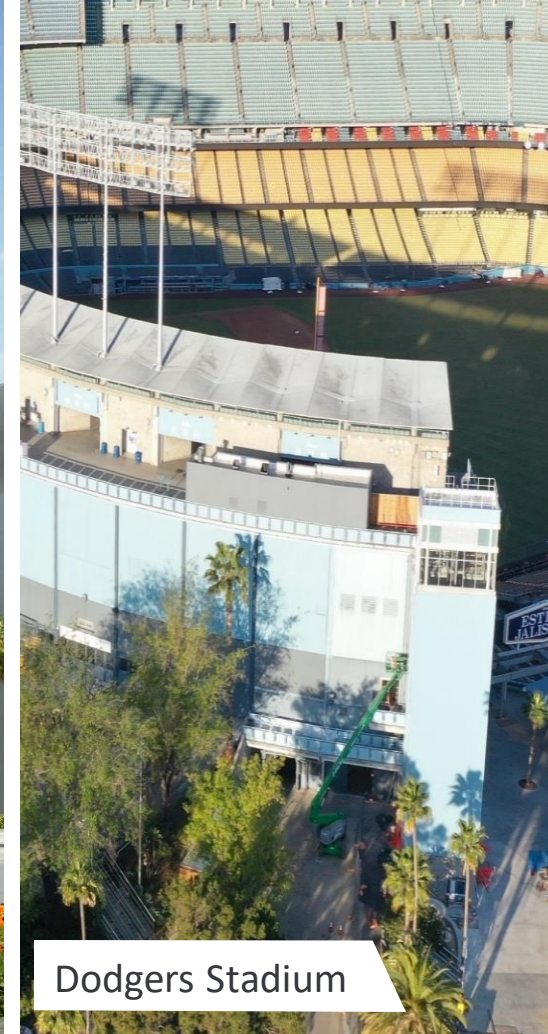

Dodgers Stadium



CONSTRUCTION

ORANGE COUNTY

| Building a better future, together.



Axiom Store



Cal State Fullerton McCarthy Hall Renovation



Cal State Fullerton Pollak Library



CONSTRUCTION

SAN DIEGO

| Building a better future, together.

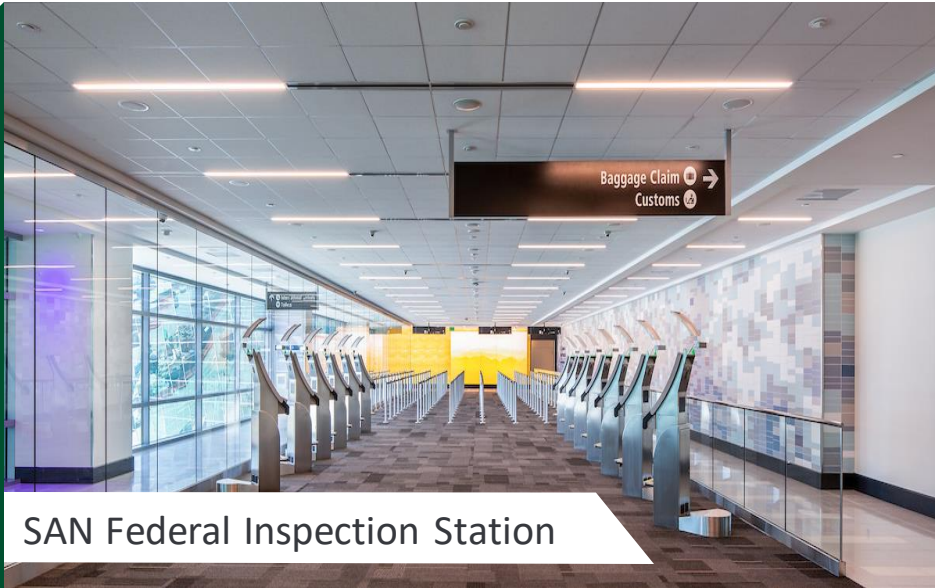

SAN Federal Inspection Station

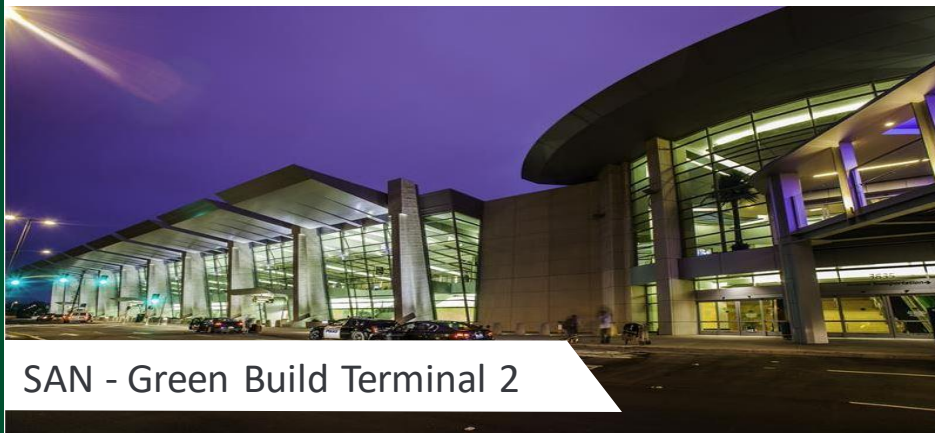

SAN - Green Build Terminal 2

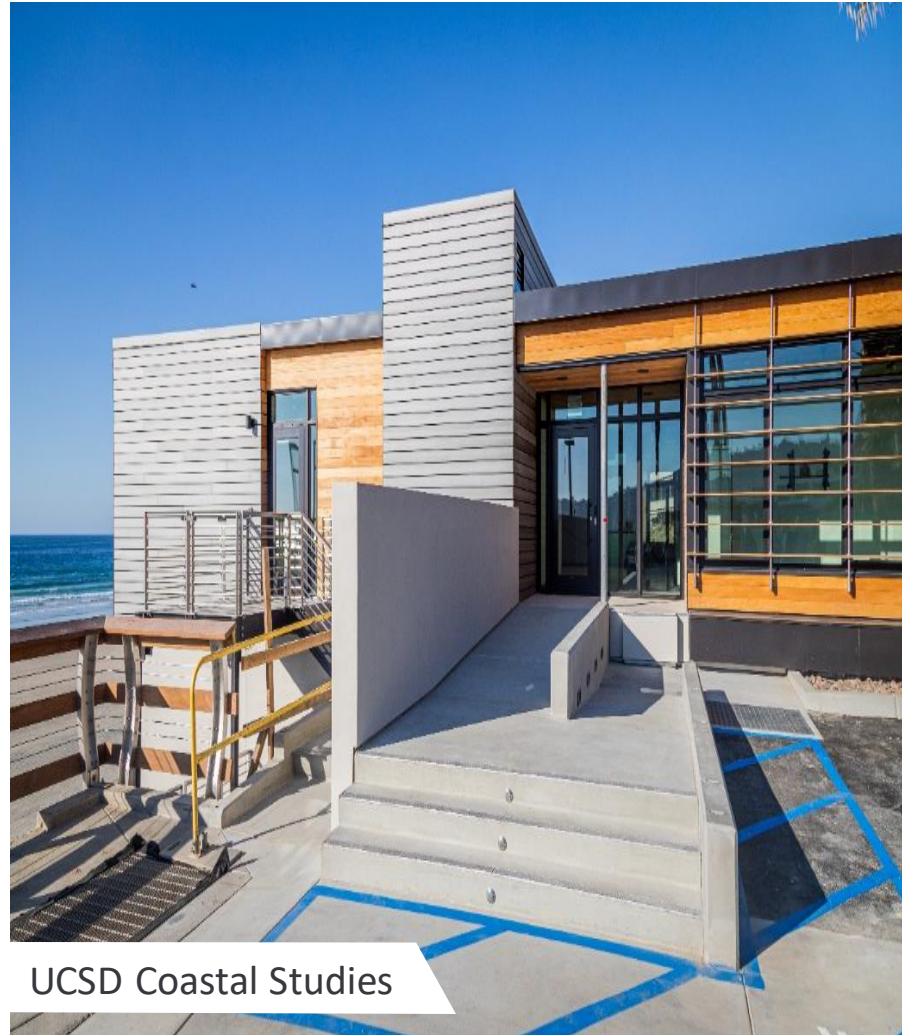

UCSD Coastal Studies

AVIATION

- ▶ San Diego International Airport Federal Inspection Station
- ▶ San Diego International Airport- Green Build Terminal Two

HIGHER EDUCATION

- ▶ UCSD Coastal Studies



CONSTRUCTION

SAN DIEGO

| Building a better future, together.



UCSD Marine Conservation and Technology Facility



San Elijo Water Reclamation Facility



El Corazon Aquatic Facility



Saddleback College Stadium

HIGHER EDUCATION (CONT.)

- ▶ UCSD Marine Conservation and Technology Facility
- ▶ Saddleback College Stadium

PUBLIC WORKS

- ▶ El Corazon Aquatic Facility
- ▶ San Elijo Water Reclamation Facility



CONSTRUCTION

SAN DIEGO

| Building a better future, together.



Southeastern Live Well Center

UPCOMING BIDS

- ▶ UAL – Cargo & GSE Tis
- ▶ Blue Nalu
- ▶ County of San Diego – Lakeside Library
- ▶ County of San Diego – Southeastern Live Well Center
- ▶ University of California San Diego – Revelle College Seismic Upgrades

HOW TO PREQUALIFY



CONSTRUCTION

WHO NEEDS TO PREQUALIFY?



**CSLB Contractors
License**



Surveying or Security



Supply & Install

WHY DO I NEED TO PREQUALIFY?



Subcontractor Default Insurance



Procurement Database



Invitations to Bid



CONSTRUCTION

SUBCONTRACTOR PREQUALIFICATION INSTRUCTIONS

WHY TEAM WITH PCL?

PCL is a construction contractor that knows the most important part of the construction business lies in the value of working relationships. PCL applies a collaborative approach to construction and has developed systems and processes that make collaboration easy. Your partnership with PCL is enhanced through:

- » Our Subguard Program
- » Electronic Payment System
- » Mentoring and Support

PREQUALIFICATION PROCESS: EASY AS 1-2-3!

1

Email us at CABPrequal@pcl.com and provide a contact name, email address and phone number. A representative will then contact you with access to PCL's prequalification site.

The following information will be required to complete the application.

- » Dunn & Bradstreet Number
- » Surety Information (if applicable)
- » Current/Past project list and references (2)
- » DIR Registration Number
- » Insurance Information
- » Current and past annual construction revenues
- » Contractor's License Number
- » Bank Information
- » OSHA 300 Logs from previous 3 years
- » M/W/S/DV/DBE Certification(s)
- » Current Financial Statement
- » Independent EMR verification letter (last 3 years)
- » Union Info (as applicable)
- » 4 Supplier References

2

Once complete, your application will be processed and you will be notified when it is complete.

3

Stay in touch. If you need help with the prequalification, please contact us. Additionally, be on the lookout for announcements and invitations to future networking sessions and trainings.



Shane Lundeborg | Prequalification Coordinator
P: 818.265.5342 | SLundeborg@pcl.com
California Buildings

PCL values diversity within our company and in our business partners. Our policy is to afford every practical opportunity for small, minority, women, local, veteran, and disabled veteran enterprises to participate in our projects. We want to ensure that equitable opportunity is provided to these various business concerns to be gainfully employed on our jobsites. PCL strives to maximize the utilization of these businesses on all of our projects, regardless of project-specific goals.

NEXT STEPS



SLUNDEBERG@PCL.COM || 818.265.5342

HELPFUL TIPS



**2019 or Newer
Information**



Notes Section



**Let Us Know How
We Can Help You!**

TAKEAWAYS



CONSTRUCTION

REMEMBER

| Building a better future, together.



YOU ARE ESSENTIAL



WE ARE BETTER TOGETHER



PREQUALIFY! PREQUALIFY!



RELATIONSHIP MANAGEMENT



| WATCH US BUILD AT [PCL.COM](https://www.pcl.com)



QUESTIONS?



| WATCH US BUILD AT [PCL.COM](https://www.pcl.com)

THANK
YOU!



MEET *the* PRIMES

www.SANMTP2020.Eventbrite.com



JOIN US AT OUR UPCOMING MEET THE PRIMES SESSIONS

Tues., Oct. 27, 2020

9:30 a.m. - 10:30 a.m. Swinerton
4 p.m. - 5 p.m. Turner Construction

Wed., Oct. 28, 2020

8 a.m. - 9 a.m. Hensel Phelps
9 a.m. - 10 a.m. Sundt Construction
2 p.m. - 3 p.m. Clark Construction
4 p.m. - 5 p.m. Jacobs

Thurs., Oct. 29, 2020

9:30 a.m. - 10:30 a.m. AECOM
11 a.m. - 12:30 p.m. Airport Concessionaire Panel
Featuring:
Hudson Group,
HMSHost,
S&C Robinson Enterprise
SSP America
S. Levy Foods
3 p.m. - 4:30 p.m. Airport Concessionaire Panel
Featuring:
Mission Yogurt
SFS Beauty Ca, LLC
P&P Services, LLC
High Flying Foods
Procurement Concepts Inc.

Tues., Nov. 3, 2020

8:30 a.m. - 9 a.m. Small Business Development Dept.
9:30 a.m. - 10 a.m. Facilities Management Dept.
10:30 a.m. - 11 a.m. Procurement Dept.
11:30 a.m. - 12 p.m. Labor Compliance Dept.
1:30 p.m. - 2 p.m. Revenue Generation & Partnership Development - Food & Beverage/Retail
2:20 p.m. - 3 p.m. Quieter Home Program
4 p.m. - 5 p.m. Airport Design & Construction

Wed., Nov. 4, 2020

10 a.m. - 11:30 a.m. Public Agencies & Business Support Services Panel, Featuring:
Procurement Technical Assistance Center (PTAC), SANDAG, CALTRANS District 11, County of San Diego, North County Transit District, San Diego County Water Authority, Port of San Diego, University of California San Diego
1 p.m. - 2 p.m. Public Agencies & Business Support Services Panel, Featuring:
San Diego & Imperial Valley Small Business Development Center (SBDC), City of San Diego, San Diego Unified School District, U.S. Veteran Business Alliance (USVBA) San Diego Chapter, Business Incentive Credits